

AGL

QUICK GUIDE

This document is a concise version of the model manual. This document is not meant to be a replacement of the manual. To download the full manual please scan the QRcode below or locate the data label on the model and scan the QRcode.

ECO™ heat transfer coolers



CE
EAC
UK
CA

MODINE

MANUFACTURER:
MODINE GIS ITALY S.R.L.
VIA GIULIO LOCATELLI, 22
33050 POCENIA (UDINE) ITALY

MADE IN ITALY/EU

MODEL AGC252E4

SERIAL NR. AA123456789 DATE 01/01/2021

NET WEIGHT [KG] 24 CAPACITY [L] 2.2

CUSTOMER CODE

PS [BAR] 30 FLUID GROUP 1. G

TS MAX/MIN [°C] 125/-40 VOL [L]

CAT (PED) Art. 4 par. 3 DN 20

NR. OF MOTORS 02 RPM 1300-1400

MOTORS POW. SUPPLY 230V/1/50-60HZ

TOT. 190 W 1.4 A

HEATERS POWER SUPPLY 380V/3/50-60HZ

HEATERS TOT 2250W

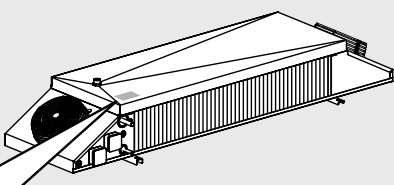

ECO™ heat transfer coolers



CE
EAC
UK
CA

MODINE



Link to user manuals:



IT ES
EN FR
DE RU



! Before removing the packaging, handling, assembling, positioning, commissioning of the machine and before performing any work on the model, download and carefully read all the information in the manual. If in doubt contact Modine.

Construction and dimensional features

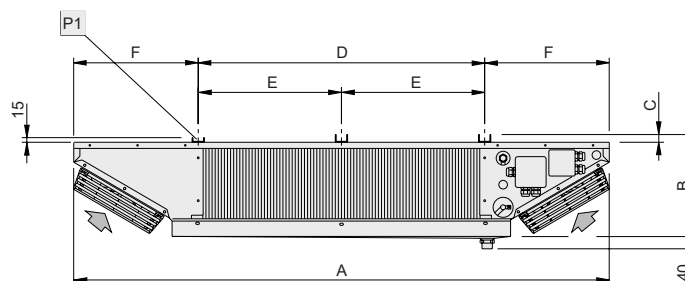
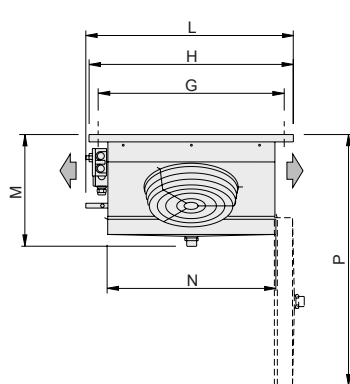

Fastening detail P1

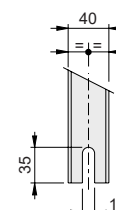

Model		AGL	21EM5	22EM5	23EM5	34EM5	34FM5
Motorfans	n° x Ø mm		2x250	2x250	2x250	2x315	3x315
	A		1740	2190	2640	3230	3230
	B		331	331	346	346	346
	C		25	25	40	40	40
	D		930	1380	1830	2280	2280
	E		-	-	915	1140	1140
	F		405	405	405	475	475
	G		618	618	618	735	735
	H		678	678	678	795	795
	L		695	695	695	810	810
Dimensions	M		371	371	386	386	386
	N		560	560	560	680	680
	P		850	850	865	980	980
	In (mm)		12	16	16	16	16
	Out (mm)		16	22	22	28	28
	Ø (GAS)		1"	1"	1"	1"	1"
Net weight	kg		34	40	50	65	72

Use thermostatic valve with external pressure equalizer

Wiring diagrams

Motor-fan connection diagram

Important. The motors are equipped with inner thermal protection with automatic reconnection. Before using motor speed control systems verify the compatibility with the motors. Non compatible systems may damage motors or increase noise level; Modine will not be responsible for model performance with speed control systems. For fans equipped with thermal contacts (TK), these must be connected to the control circuit. For models supplied with wiring in a junction box, remove the cover to make the connection.

Model	AGL	21EM5		22EM5		23RM5		34EM5		34FM5	
Motorfans	n° x Ø mm	2x250		2x250		2x250		2x315		2x315	
Frequency	Hz	50	60	50	60	50	60	50	60	50	60
Electrical consumption	A	1.32	1.32	1.32	1.32	1.32	1.32	0.86	1.16	0.86	1.16
	W	190	190	190	190	190	190	192	260	192	260
RPM		1300	1400	1300	1400	1300	1400	1340	1490	1340	1490

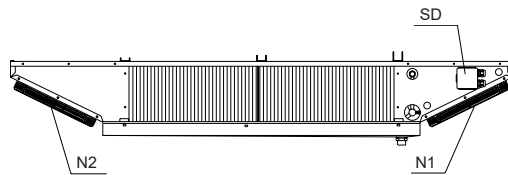

N1 = fan n. 1
 N2 = fan n. 2
 SD = junction box

Ø250 fan diameter unit

Ø315 fan diameter unit

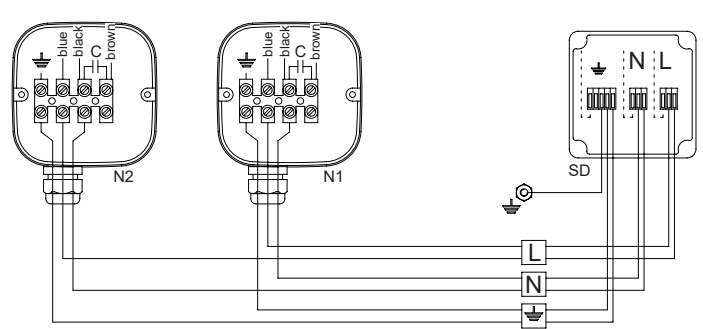
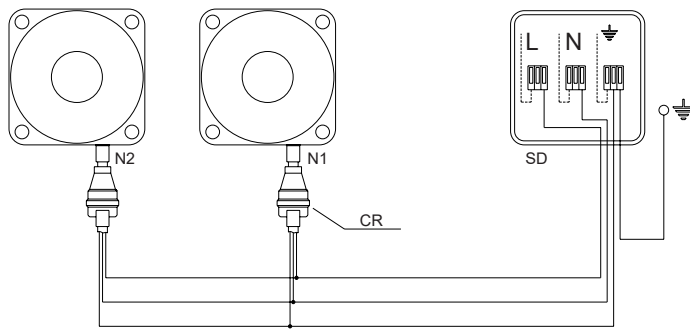

- = yellow-green
- L = brown
- N = blue
- CR = cable quick connection
- SD = junction box
- N1 = fan n. 1
- N2 = fan n. 2



Modine CIS Italy S.r.l.
 33050 Pocenia - Udine - Italy
 Via Giulio Locatelli, 22
 Tel. +39 0432.772.001
 Fax +39 0432.779.594
 www.modine.com

Link to user manuals:

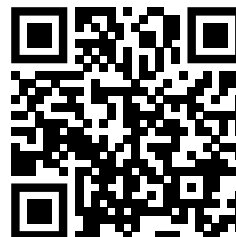

<https://www.modinecoolers.com/documents/>