

# GCE

# QUICK GUIDE

This document is a concise version of the model manual. This document is not meant to be a replacement of the manual. To download the full manual please scan the QRcode below or locate the data label on the model and scan the QRcode.

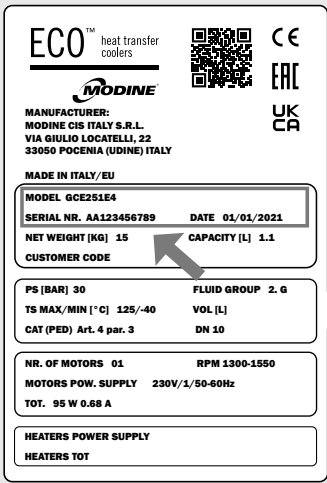

**ECO™** heat transfer coolers  
**MODINE**

MANUFACTURER:  
 MODINE CIS ITALY S.R.L.  
 VIA GIULIO LOCATELLI, 22  
 33050 POCCENIA (UDINE) ITALY

MADE IN ITALY/EU

MODEL GCE251E4	DATE 01/01/2021
SERIAL NR. AA123456789	CAPACITY [L] 1.1
NET WEIGHT [KG] 15	CUSTOMER CODE

PS [BAR] 30	FLUID GROUP 2.0
TS MAX./MIN [°C] 125/-40	VOL [L]
CAT (PED) Art. 4 par. 3	DN 10

NR. OF MOTORS 01	RPM 1300-1550
MOTORS POW. SUPPLY 230V/1/50-60Hz	
TOT. 95 W 0.68 A	

HEATERS POWER SUPPLY	
HEATERS TOT	

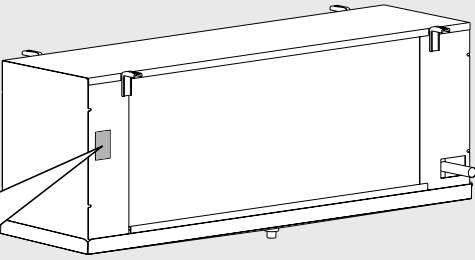

**ECO™** heat transfer coolers  
**MODINE**

CE  
 EAC  
 UK  
 CA

QR code for manuals

Link to user manuals:

QR code for manuals

IT ES  
 EN FR  
 DE RU

! Before removing the packaging, handling, assembling, positioning, commissioning of the machine and before performing any work on the model, download and carefully read all the information in the manual. If in doubt contact Modine.

## Construction and dimensional features

### Ø250 fan diameter unit

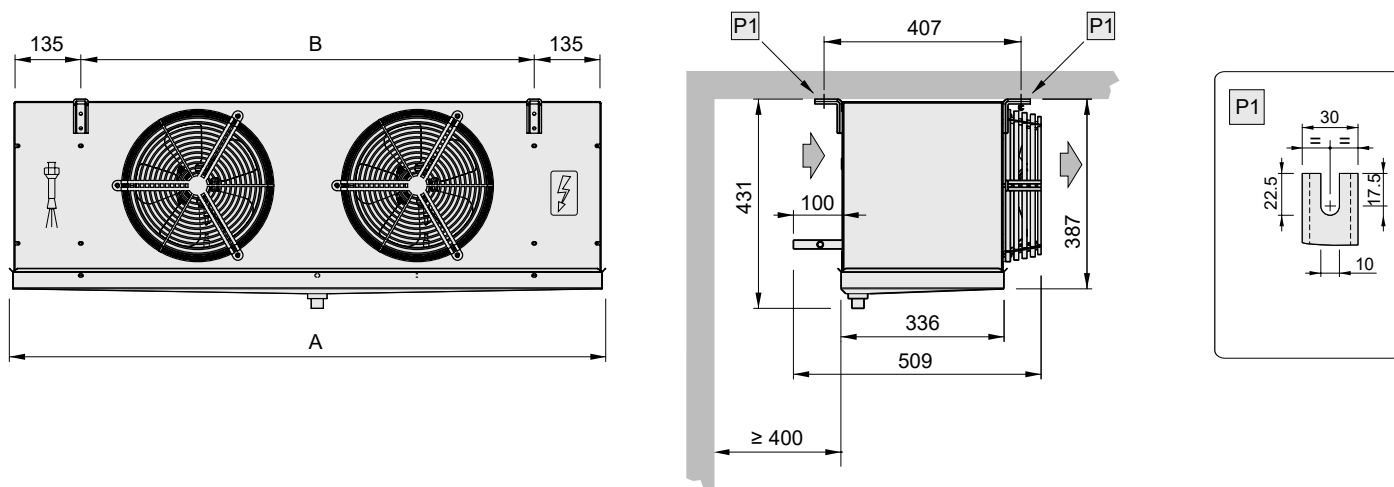

### Ø315 fan diameter unit

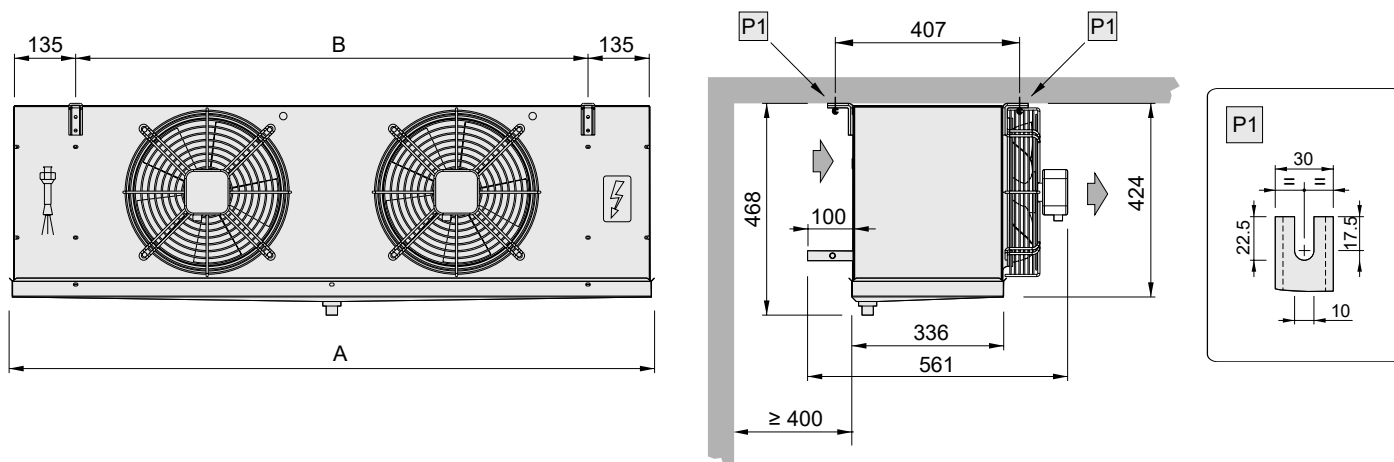

Model	GCE	251E4R	251E4	252G4	252E4	253G4	253E4	254G4	254E4	311F4	312F4	313F4	314F4
		251E6R	251E6	252G6	252E6	253G6	253E6	254G6	254E6	311F6	312F6	313F6	314F6
		251E8R	251E8	252G8	252E8	253G8	253E8	254G8	254E8	311F8	312F8	313F8	314F8
Motorfans	n° x Ø mm	1x250	1x250	2x250	2x250	3x250	3x250	4x250	4x250	1x315	2x315	3x315	4x315
Dimensions	A [mm]	674	774	1224	1224	1674	1674	2124	2124	874	1424	1974	2524
	B [mm]	380	480	930	930	1380	1380	1830	1830	580	1130	1680	2230
Coil connections	In [mm]	12	12	12	12	12	12	12	16	12	12	16	16 (F4: 22)
	Out [mm]	12	12	22	22	22	22	22 (G4:28)	28	22	28	28	28 (F8: 35)
Drain connection	Ø (GAS)	1"	1"	1"	1"	1"	1"	1"	1"	1"	1"	1"	1"
Net weight	kg	13	14.5	21.5	24	30	33	38	41.5	20	34	47.5	61

Ø350 fan diameter unit

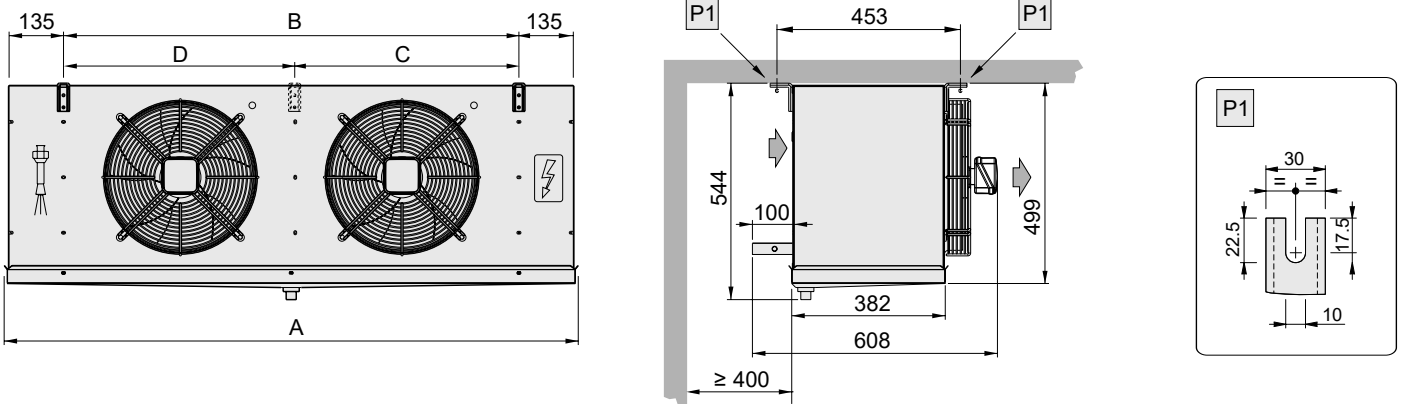

Model	GCE	351E4	351A4	352E4	352A4	353F4	353A4	354F4	354A4	355A4
		351E6	351A6	352E6	352A6	353F6	353A6	354F6	354A6	355A6
		351E8	351A8	352E8	352A8	353F8	353A8	354F8	354A8	355A8
Motorfans	n° x Ø mm	1x350	1x350	2x350	2x350	3x350	3x350	4x350	4x350	5x350
Dimensions	A [mm]	875	875	1425	1425	1975	1975	2525	2525	3075
	B [mm]	580	580	1130	1130	1680	1680	2230	2230	2780
	C [mm]	-	-	-	-	-	-	1115	1115	1665
	D [mm]	-	-	-	-	-	-	1115	1115	1115
Coil connections	In [mm]	12	12	16	16	16 (F4: 22)	22	22	28	28
	Out [mm]	22	22	28	28	28 (F8: 35)	35	35 (F8: 42)	42	42
Drain connection	Ø (GAS)	1"	1"	1"	1"	1"	1"	1"	1"	1"
Net weight	kg	22	26.5	41	48	58	63	77	83.5	103

XXXXXX : Thermostatic valve with external pressure equaliser recommended

Inspection - Storage







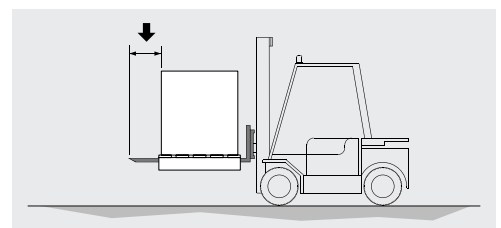

- 1.1 Upon receipt of the model immediately check its state of integrity; immediately dispute with the transport company any damage. The packaging is created according to the model, to the suitable means of transport and of handling.
- 1.2 The model must be stored in its original packaging in a place that is protected and away from weathering.
- 1.3 Do not place any other material on top of the packaging.
- 1.4 If the model is allowed to be stacked, follow the instructions on the packaging.
- 1.5 If a motor fan is switched OFF for a long period of time, it must be switched ON for at least 2 hours every month to remove any traces of condensation that may have formed inside the motor.
- 1.6 The following rules apply when the unit must remain in storage for long periods of time. The unit must be stored indoors and positioned according to the instructions on the package. During storage, the fans must be manually rotated at least once every 3 months.

Handling and installation

- 1.1 The models are supplied in a cardboard box and/or wooden cage.
- 1.2 The packaged model must be moved by qualified personnel using a forklift truck of suitable capacity, or with crane and/or overhead crane. The lifting brackets must be longer than the depth of the packaging and/or of the model. Avoid any abrupt movement and do not stand close to the manoeuvring area. Always ensure that the models are secured to the hoists before handling operations. A heavy impact or a strong thrust can overturn the model.
- 1.3 The model must always be kept in position as indicated on the packaging.
- 1.4 Avoid applying improper pressure to the packaging during handling. Take care not to damage the headers.



- 1.5 Unpack the unit close to the installation site.
- 1.6 Always use PPE (Personal Protection Equipment) during handling and installation, e.g. gloves that are sufficiently resistant to mechanical hazards, to reduce the risk of injury in the event of contact with sharp sheet metal edges or the finned pack.
- 1.7 It is essential to take all the necessary measures to ensure the complete safety of the operators in order to prevent the model from accidentally falling against people. It is forbidden to work under a suspended load. It is advisable to prepare a structure of greater capacity than the weight to be supported (trestle or props) on which to place the model.
- 1.8 When installation is complete, remove the protective film covering the model.
- 1.9 When installation is complete, dispose of packaging according to local regulations.
- 1.10 If brackets are provided, install and maintain them for future use.
- 1.11 The following table summarises the PPE (Personal Protection Equipment) to be used during the various phases of the life of the equipment (each stage involves the obligation to use and provide PPE), in order to protect the health and safety of operators.
- 1.12 The responsibility for the identification and choice of the type and category of PPE that is appropriate and suitable lies with the user.
- 1.13 The PPE used must comply with the directives of the product and bear the CE marking (for the European market).

Phase								
	Protective clothing	Safety footwear	Gloves	Goggles	Visor	Ear protectors	Mask	Helmet or head gear
Transportation	NP	NP	NP	NP	NP	NP	NP	NP
Handling	X	X	X	X	NP	NP	NP	X
Unpacking	X	X	X	X	NP	NP	NP	X
Assembly	X	X	X	X	NP	O	NP	X
Ordinary use	NP	NP	NP	NP	NP	NP	NP	NP
Adjustments	X	X	X	NP	X	O	NP	NP
Cleaning	X	X	X	NP	X	O	X	NP
Maintenance	X	X	X	NP	X	O	O	X
Dismantling	X	X	X	NP	X	O	NP	X
Demolition	X	X	X	X	NP	O	NP	O

X : Recommended PPE

O : PPE available or to be used if necessary

NP : PPE not recommended

## Wiring diagrams

### Motor-fan connection diagram

**Important.** The motors are equipped with inner thermal protection with automatic reconnection. Before using motor speed control systems verify the compatibility with the motors. Non compatible systems may damage motors or increase noise level; Modine will not be responsible for model performance with speed control systems. For fans equipped with thermal contacts (TK), these must be connected to the control circuit. For models supplied with wiring in a junction box, remove the cover to make the connection.

Model	GCE	251E4R	251E4	252G4	252E4	253G4	253E4	254G4	254E4
		251E6R	251E6	252G6	252E6	253G6	253E6	254G6	254E6
		251E8R	251E8	252G8	252E8	253G8	253E8	254G8	254E8
Motorfans	n° x Ø mm	1x250		2x250		3x250		4x250	
Frequency	Hz	50	60	50	60	50	60	50	60
Electrical consumption	A	0.66	0.66	1.32	1.32	1.98	1.98	2.64	2.64
	W	95	95	190	190	285	285	380	380
RPM		1300	1400	1300	1400	1300	1400	1300	1400

Model	GCE	311F4	312F4	313F4	314F4
		311F6	312F6	313F6	314F6
		311F8	312F8	313F8	314F8
Motorfans	n° x Ø mm	1x315		2x315	
Frequency	Hz	50	60	50	60
Electrical consumption	A	0.52	0.66	1.04	1.32
	W	110	148	220	296
RPM		1350	1490	1350	1490

Model	GCE	351E4	351A4	352E4	352A4	353F4	353A4	354F4	354A4	355A4	
		351E6	351A6	352E6	352A6	353F6	353A6	354F6	354A6	355A6	
		351E8	351A8	352E8	352A8	353F8	353A8	354F8	354A8	355A8	
Motorfans	n° x Ø mm	1x350		2x350		3x350		4x350		5x350	
Frequency	Hz	50	60	50	60	50	60	50	60	50	60
Electrical consumption	A	0.96	1.08	1.92	2.16	2.88	3.24	3.84	4.32	4.80	5.40
	W	185	250	370	500	555	750	740	1000	925	1250
RPM		1450	1700	1450	1700	1450	1700	1450	1700	1450	1700

**Ø250 fan diameter unit**

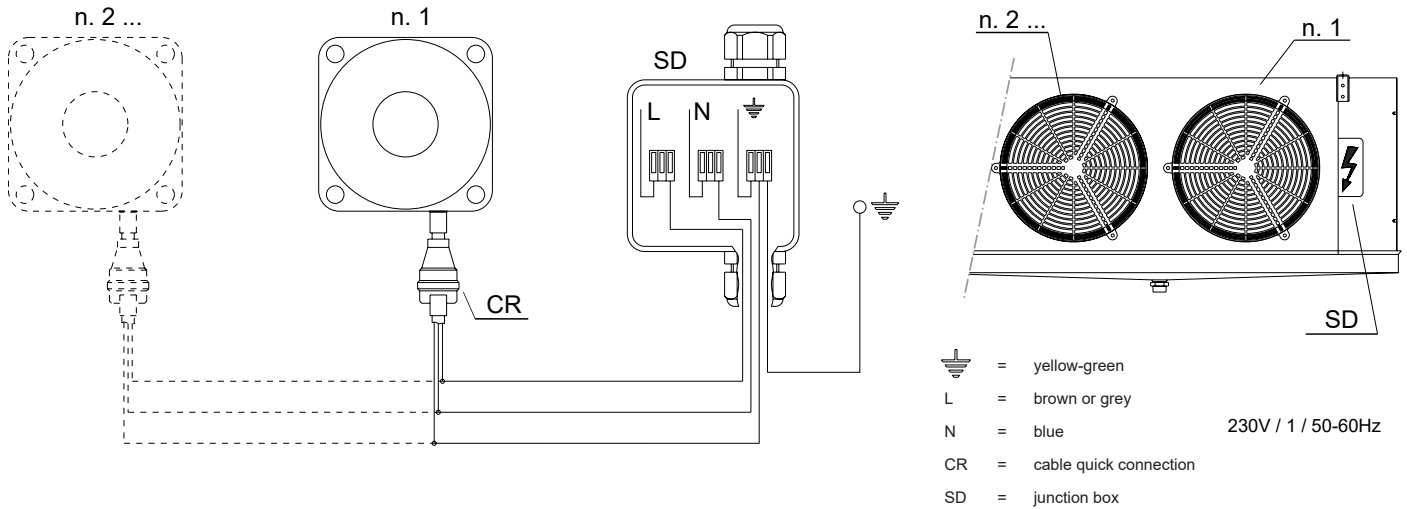

**Ø315-Ø350 fan diameter unit**

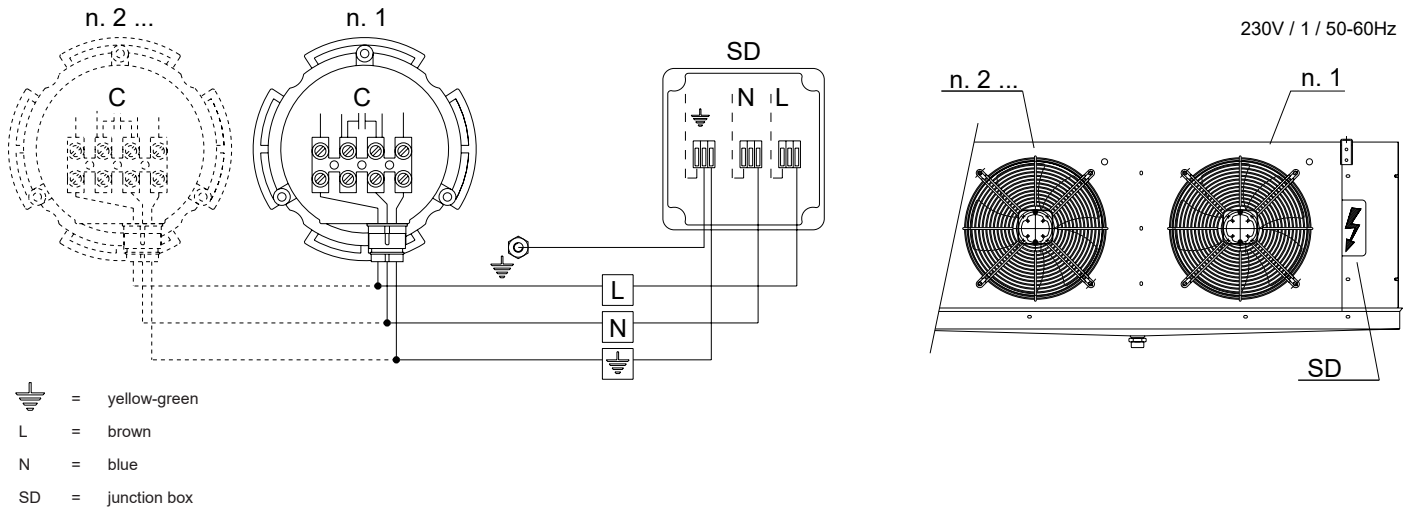

Modine CIS Italy S.r.l.  
 33050 Pocenia - Udine - Italy  
 Via Giulio Locatelli, 22  
 Tel. +39 0432.772.001  
 Fax +39 0432.779.594  
 www.modine.com

Link to user manuals:

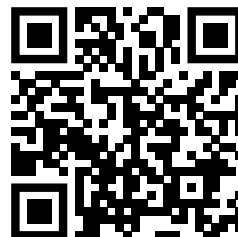

<https://www.modinecoolers.com/documents/>