

AGL

QUICK GUIDE

This document is a concise version of the model manual. This document is not meant to be a replacement of the manual. To download the full manual please scan the QRcode below or locate the data label on the model and scan the QRcode.

ECO™ heat transfer coolers



CE
ERC
UK CA

MODINE

MANUFACTURER:
MODINE GIS ITALY S.R.L.
VIA GIULIO LOCATELLI, 22
33050 POCENIA (UDINE) ITALY

MADE IN ITALY/EU

MODEL AGC252E4

SERIAL NR. AA123456789 DATE 01/01/2021

NET WEIGHT [KG] 24 CAPACITY [L] 2.2

CUSTOMER CODE

PS [BAR] 30 FLUID GROUP 1. G

TS MAX/MIN [°C] 125/-40 VOL [L]

CAT (PED) Art. 4 par. 3 DN 20

NR. OF MOTORS 02 RPM 1300-1400

MOTORS POW. SUPPLY 230V/1/50-60HZ

TOT. 190 W 1.4 A

HEATERS POWER SUPPLY 380V/3/50-60HZ

HEATERS TOT 2250W

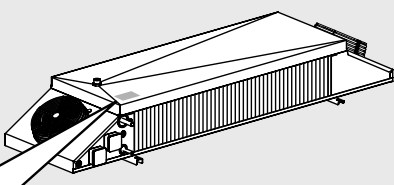

ECO™ heat transfer coolers



CE
ERC
UK CA

MODINE



Link to user manuals:



IT ES
EN FR
DE RU



! Before removing the packaging, handling, assembling, positioning, commissioning of the machine and before performing any work on the model, download and carefully read all the information in the manual. If in doubt contact Modine.

Construction and dimensional features

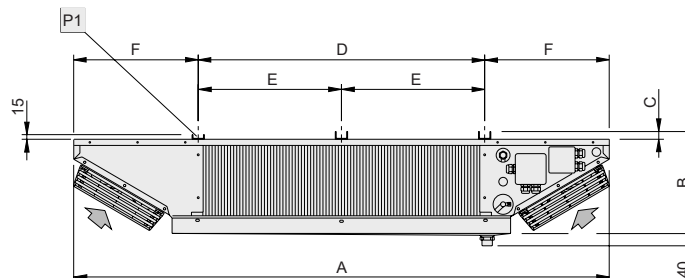
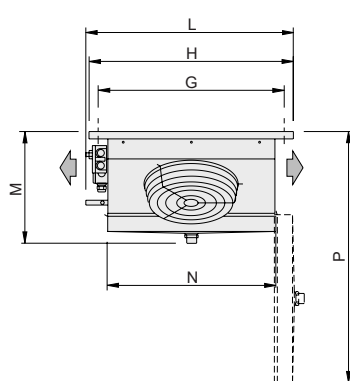

Fastening detail P1

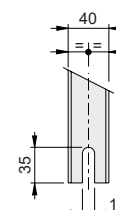

| Model | | AGL | 21EM5 | 22EM5 | 23EM5 | 34EM5 | 34FM5 |
|------------------|-----------|-----|-------|-------|-------|-------|-------|
| Motorfans | n° x Ø mm | | 2x250 | 2x250 | 2x250 | 2x315 | 3x315 |
| | A | | 1740 | 2190 | 2640 | 3230 | 3230 |
| Dimensions | B | | 331 | 331 | 346 | 346 | 346 |
| | C | | 25 | 25 | 40 | 40 | 40 |
| | D | | 930 | 1380 | 1830 | 2280 | 2280 |
| | E | | - | - | 915 | 1140 | 1140 |
| | F | | 405 | 405 | 405 | 475 | 475 |
| | G | | 618 | 618 | 618 | 735 | 735 |
| | H | | 678 | 678 | 678 | 795 | 795 |
| | L | | 695 | 695 | 695 | 810 | 810 |
| | M | | 371 | 371 | 386 | 386 | 386 |
| | N | | 560 | 560 | 560 | 680 | 680 |
| Coil connections | In (mm) | | 12 | 16 | 16 | 16 | 16 |
| | Out (mm) | | 16 | 22 | 22 | 28 | 28 |
| Drain connection | Ø (GAS) | | 1" | 1" | 1" | 1" | 1" |
| Net weight | kg | | 34 | 40 | 50 | 65 | 72 |

Thermostatic valve with external pressure equaliser recommended

Handling and installation

- 1.1 The models are supplied in a cardboard box and/or wooden cage.
- 1.2 The packaged model must be moved by qualified personnel using a forklift truck of suitable capacity, or with crane and/or overhead crane. The lifting brackets must be longer than the depth of the packaging and/or of the model. Avoid any abrupt movement and do not stand close to the manoeuvring area. Always ensure that the models are secured to the hoists before handling operations. A heavy impact or a strong thrust can overturn the model.

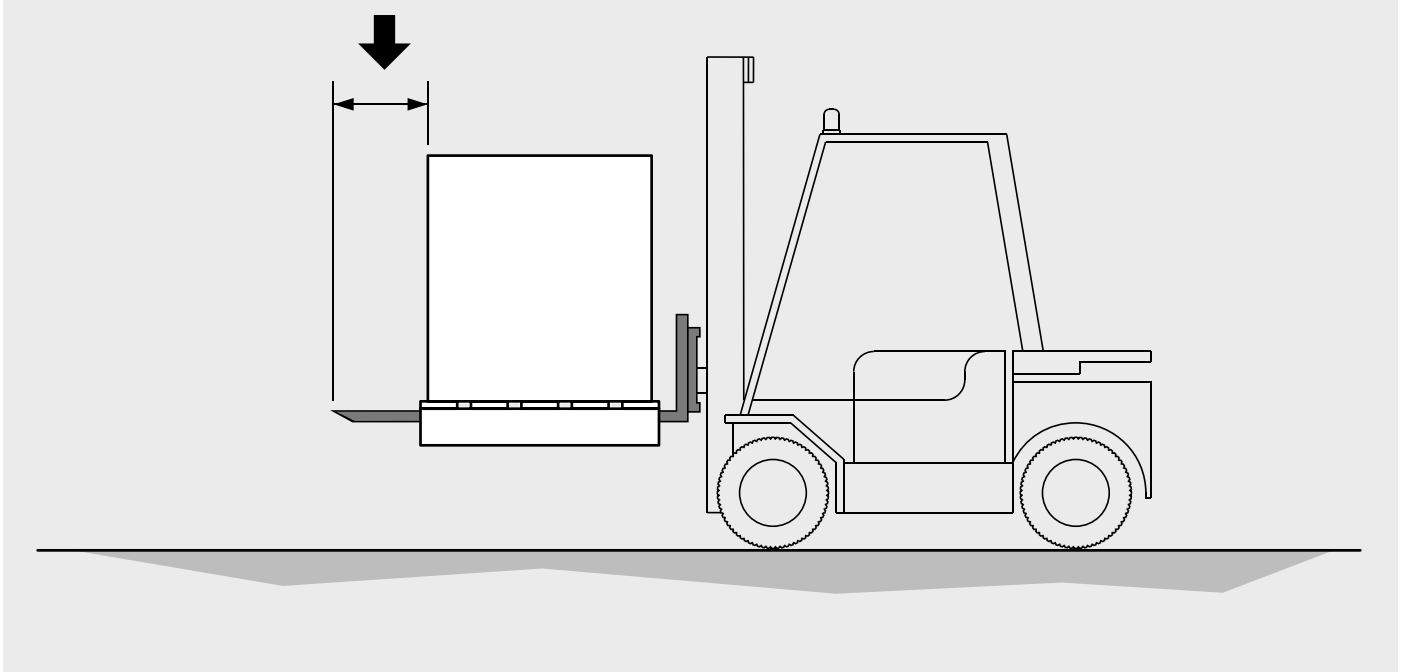

- 1.3 The model must always be kept in position as indicated on the packaging.
- 1.4 Avoid applying improper pressure to the packaging during handling. Take care not to damage the headers.
- 1.5 Unpack the unit close to the installation site.
- 1.6 Always use PPE (Personal Protection Equipment) during handling and installation, e.g. gloves that are sufficiently resistant to mechanical hazards, to reduce the risk of injury in the event of contact with sharp sheet metal edges or the finned pack.
- 1.7 It is essential to take all the necessary measures to ensure the complete safety of the operators in order to prevent the model from accidentally falling against people. It is forbidden to work under a suspended load. It is advisable to prepare a structure of greater capacity than the weight to be supported (trestle or props) on which to place the model.
- 1.8 When installation is complete, remove the protective film covering the model.
- 1.9 When installation is complete, dispose of packaging according to local regulations.
- 1.10 If brackets are provided, install and maintain them for future use.

Wiring diagrams

Motor-fan connection diagram

Important. The motors are equipped with inner thermal protection with automatic reconnection. Before using motor speed control systems verify the compatibility with the motors. Non compatible systems may damage motors or increase noise level; Modine will not be responsible for model performance with speed control systems. For fans equipped with thermal contacts (TK), these must be connected to the control circuit. For models supplied with wiring in a junction box, remove the cover to make the connection.

| Model | AGL | 21EM5 | | 22EM5 | | 23RM5 | | 34EM5 | | 34FM5 | |
|------------------------|-----------|-------|------|-------|------|-------|------|-------|------|-------|------|
| Motorfans | n° x Ø mm | 2x250 | | 2x250 | | 2x250 | | 2x315 | | 2x315 | |
| Frequency | Hz | 50 | 60 | 50 | 60 | 50 | 60 | 50 | 60 | 50 | 60 |
| Electrical consumption | A | 1.32 | 1.32 | 1.32 | 1.32 | 1.32 | 1.32 | 0.86 | 1.16 | 0.86 | 1.16 |
| | W | 190 | 190 | 190 | 190 | 190 | 190 | 192 | 260 | 192 | 260 |
| RPM | | 1300 | 1400 | 1300 | 1400 | 1300 | 1400 | 1340 | 1490 | 1340 | 1490 |

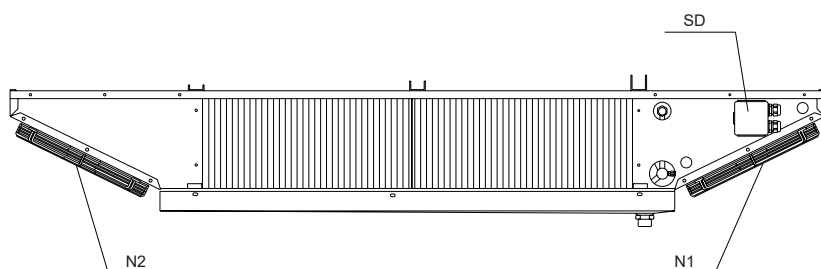

- N1 = fan n. 1
- N2 = fan n. 2
- SD = junction box

Ø250 fan diameter unit

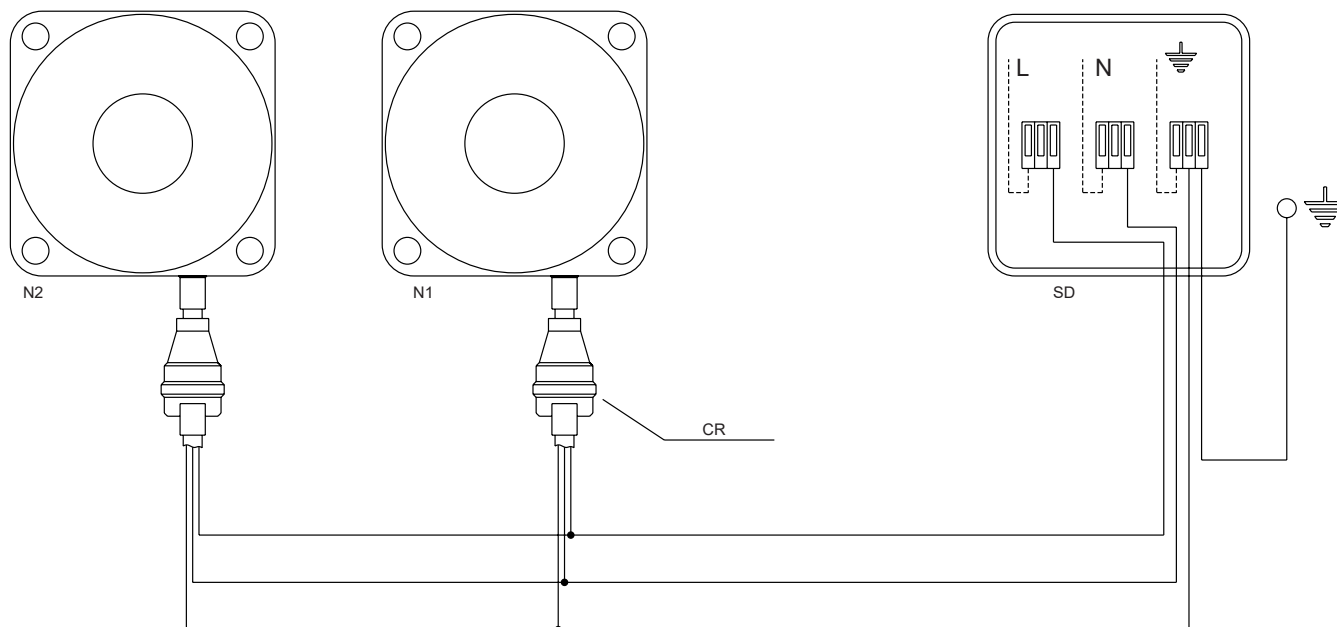

-  = yellow-green
- L = brown
- N = blue
- CR = cable quick connection
- SD = junction box
- N1 = fan n. 1
- N2 = fan n. 2

Ø315 fan diameter unit

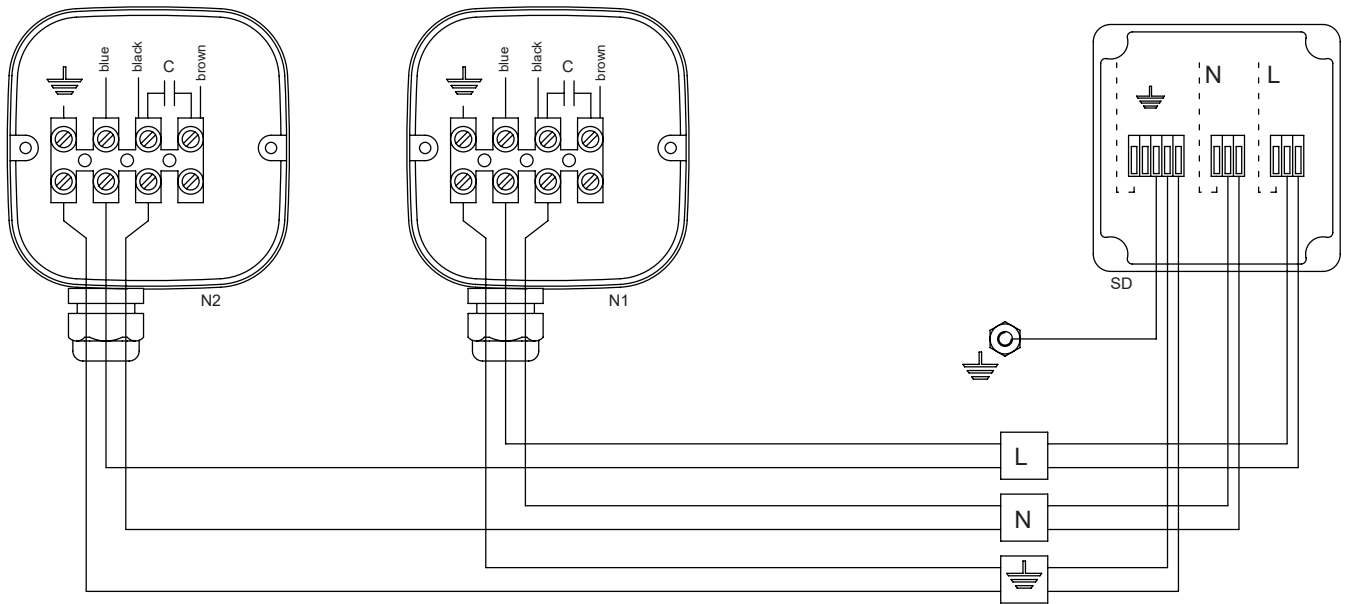

- = yellow-green
- L = brown
- N = blue
- SD = junction box
- N1 = fan n. 1
- N2 = fan n. 2

Notes



Modine CIS Italy S.r.l.
33050 Pocenia - Udine - Italy
Via Giulio Locatelli, 22
Tel. +39 0432.772.001
Fax +39 0432.779.594
www.modine.com

Link to user manuals:

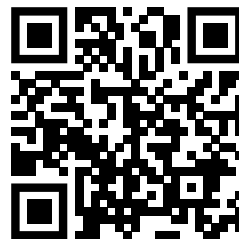

<https://www.modinecoolers.com/documents/>